



GRAND SOLIS

PREMIUM OFFICE SPACES,
NEAR LAKAKI, OFF F C ROAD

PROUDLY CRAFTED BY





SAY HELLO TO GRAND SOLIS

Designed to Inspire, Built to Lead!

Inspired by the grandeur of the sun, it is not just an address—it's an experience. Designed to elevate your ambitions and empower your business, this is where ideas shine, deals spark, and success thrives.

With cutting-edge architecture and thoughtfully curated spaces, Grand Solis sets the perfect stage for enterprises that aim to soar. From the smallest detail to the grandest design, every inch here is crafted for those who dare to dream big and work bigger.

IQ, EQ, HQ

THE LANDMARK OF TOGETHERNESS

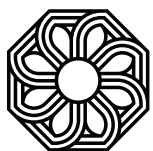

GRAND SOLIS



MAHA RERA NO.
P52100079513
maharera.maharashtra.gov.in

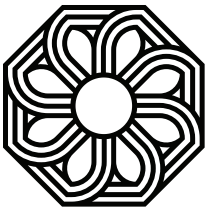

TYPICAL FLOOR PLAN

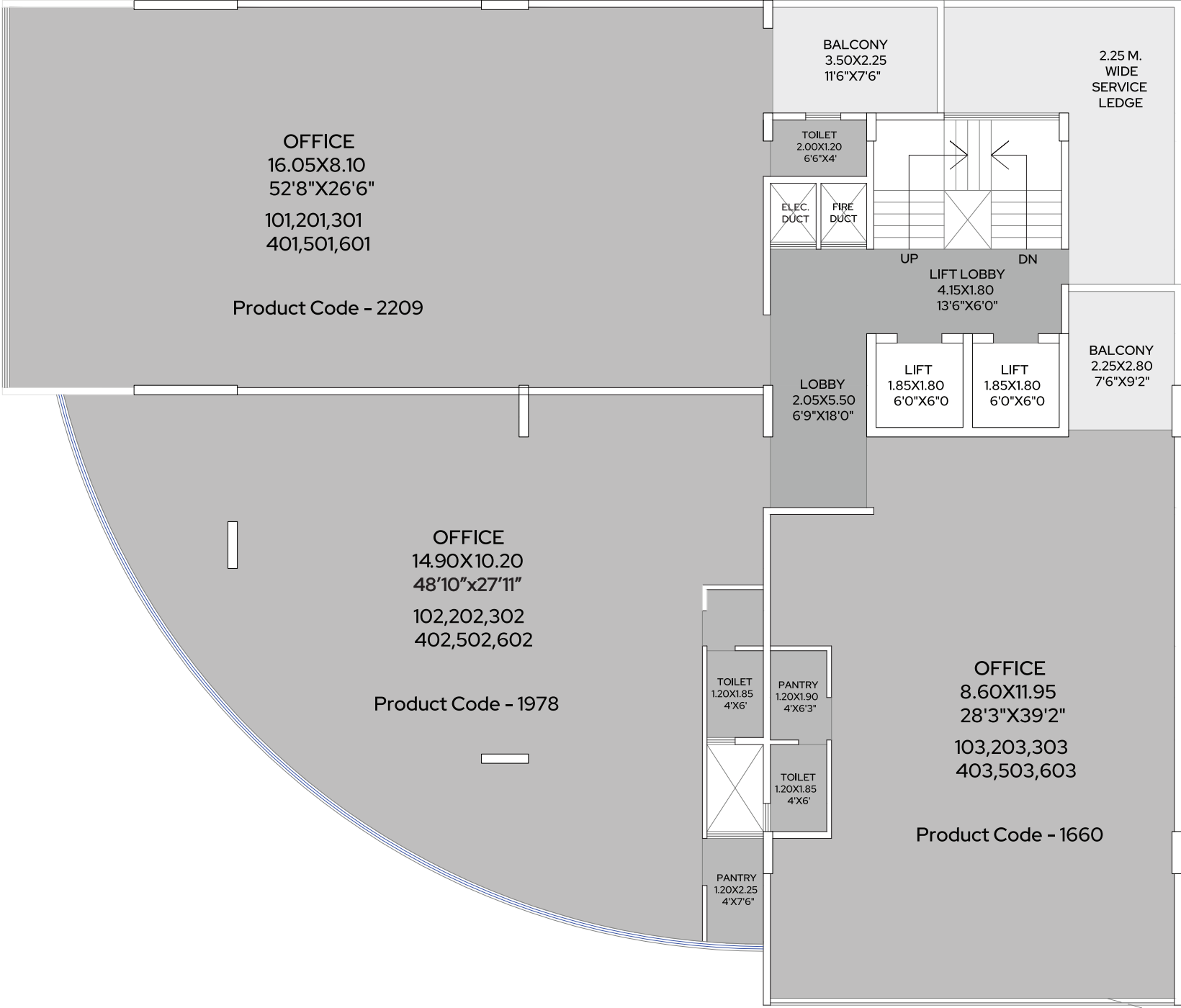



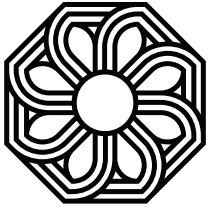

SPECIFICATIONS

Walls

- Standard R.C.C. construction in compliance with the latest National Building Code and addressing the requirements of the Seismic Zone II (Moderate Seismic Zone) as applicable to Pune.
- POP/Gypsum finishes for internal walls and ceiling. Masonry will be done in AAC blocks.

Painting

- Internal Walls: Plastic Emulsion.
- External Walls: Acrylic Paint (Brand: Asian Paints/Nerolac).

Doors

- 40 mm thick Veneer-finished doors for entrance with safety/rolling shutter.
- Granite door frames along with laminated 32 mm thick flush door shutters fitted with Mortise locks for toilets.

Windows

- Aluminium windows / fixed glass panels / structural glazing.

Pantry

- Granite platform with SS sink.
- Provision for RO / Water Purifier.

Tiling

- 800 x 800 mm vitrified tiles for internal flooring.

Electrification

- Electrical load as a one-point supply up to the DB.

Toilets

- Anti-skid flooring and 600 x 600 mm dado tiles up to ceiling height in toilets (Brand: Kajaria/Simpolo/Asian).
- Chromium-plated fittings in all toilets (Brand: Jaquar or equivalent).
- Wall-hung commodes, urinals, and wash hand basins (Brand: Hindware/Cera or equivalent).
- Concealed piping in all toilets.
- Electrical provision for exhaust fans.

COMMON AMENITIES

- Secured entrance lobby with ramp access.
- 2-8 passenger lifts with auto door (Brand: Kone or equivalent).
- Readymade tread/riser with granite finish landing.
- Decorative railing in staircase.
- Genset backup for lifts, common lighting, and water pump (Make: Kirloskar/Kohler/Cooper).



A PERFECT SYNERGY OF CRAFTSMANSHIP

Pandit Javdekar Group and Agastya Group have come together to create something truly special—an inspiring blend of tradition and innovation, where craftsmanship meets ambition.

This collaboration is all about pushing boundaries. The heritage and trusted expertise of Pandit Javdekar Group melds effortlessly with the bold vision and creativity of Agastya Group. Together, they craft spaces where every detail matters, ensuring that form meets function with style and precision.



**PANDIT[®]
JAVDEKAR**



AGASTYA

**CONTACT FOR MORE DETAILS
9923 35 3434**

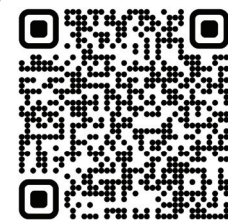
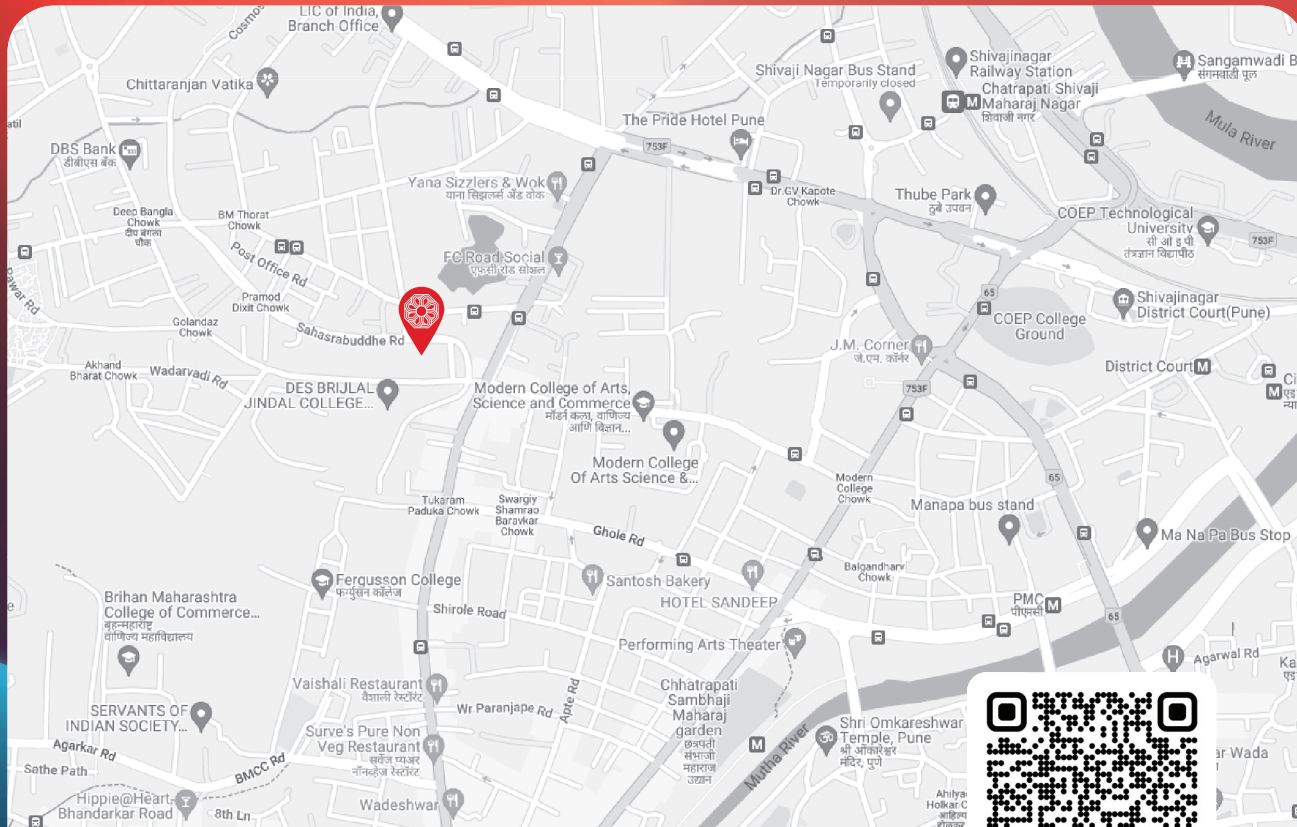

CLICK HERE FOR THE GOOGLE MAP